

LJ44-00101B PART LIST

1.MAIN

순번	자품명규격	소요량	제 조 사	대체품규격	대체품제조사	대체품규격	대체품제조사	지재위치
1	SP900SAC-29*155	1	(유)버룩스트컴퍼니코리아					
2	SP900SAC-36*155, 5HOLE	1	(유)버룩스트컴퍼니코리아					
3	SP900SAC-36*155, 6HOLE	1	(유)버룩스트컴퍼니코리아					
4	TO-220H-S9(13*18)	5	(유)버룩스트컴퍼니코리아					
5	+PAN M3*10L S/W P/W N/P	5	(주)아세아볼트					
6	+PAN M3*6L S/W P/W N/P	1	(주)아세아볼트					
7	JRW1N1R5J	1	(주)에치엠알					R8232
8	JRW1NR50J	1	(주)에치엠알					R81B9
9	RQR-07 6.8J	1	(주)에치엠알					R8013
10	TL431A-TA	8	(주)태진기술					IC8006,19,21,27,33,35,36,38
11	L8002PH-V4(PFC EER4950)	1	경인전자	L8002PH-V4(PFC EER4950)				L8002
12	L8003 8,10,14PH-V4(21Phi CS203075)	4	경인전자	L8003 8,10,14PH-V4(21Phi CS203075)				L8003, 8,10,14
13	L8004PH-V4(23Phi PFC CS229026)/Rev0.	1	경인전자	L8004PH-V4(23Phi PFC CS229026)/Rev0.6				L8004
14	L8007,9,PH-V4(3A AR6*20)	2	경인전자	L8007,9,PH-V4(3A AR6*20)				L8007,9
15	L8015PH-V4(VS EER2834)	1	경인전자	L8015PH-V4(VS EER2834)				L8015
16	L8016PH-V4(5A AR6*30)	1	경인전자	L8016PH-V4(5A AR6*30)				L8016
17	T8001PH-V4(Vsb EE1927)	1	경인전자	T8001PH-V4(Vsb EE1927)				T8001
18	T8002PH-V4(Vcc EER2834)	1	경인전자	T8002PH-V4(Vcc EER2834)				T8002
19	T8003PH-V4(Vsemi EER2834)	1	경인전자	T8003PH-V4(Vsemi EER2834)				T8003
20	T8004PH-V4(Vset EE2525)	1	경인전자	T8004PH-V4(Vset EE2525)				T8004
21	T8005PH-V4(Vscan EE2825)	1	경인전자	T8005PH-V4(Vscan EE2825)				T8005
22	T8006PH-V4(Va EE4242)	1	경인전자	T8006PH-V4(Va EE4242)				T8006
23	T8007PH-V4(Vs EER4950)	1	경인전자	T8007PH-V4(Vs EER4950)				T8007
24	T8009PH-V4(Ve EE2525)	1	경인전자	T8009PH-V4(Ve EE2525)				T8009
25	T8201PH-V4(Vdrv EE1312)	1	경인전자	T8201PH-V4(Vdrv EE1312)				T8201
26	SM3517(F3T)	2	광전자					LED8001,2
27	380*245*1.6t (PHV4_42/101B)	1	대진전자	380*245*1.6t (PHV4_50/101B)			현우산업(주)	
28	105K/63V/85℃ DMF(5mm)	2	대홍전자(주)					CS202,203
29	116*35*32,VS,D(PS-PHV4)	1	도성정밀	116*35*32,VS,D(PS-PHV4)			정승오금	H8005
30	131*35*25,BD(PS-PHV4)	1	도성정밀	131*35*25,BD(PS-PHV4)			정승오금	H8001
31	15*11*25(PS-PHV4)	1	도성정밀	15*11*25(PS-PHV4)			정승오금	H8012
32	15*11*30(PS-PHV4)	4	도성정밀	15*11*30(PS-PHV4)			정승오금	H8008,9,10,11
33	156*35*32,VS(PS-PHV4)	1	도성정밀	156*35*32,VS(PS-PHV4)			정승오금	H8007
34	156.1*35*32,PFC(PS-PHV4)	1	도성정밀	156.1*35*32,PFC(PS-PHV4)			정승오금	H8002
35	2.0t*22*8	1	도성정밀	2.0t*22*8			정승오금	
36	61*35*32,LC(PS-PHV4)	1	도성정밀	61*35*32,LC(PS-PHV4)			정승오금	H8004
37	8.5*23.8	1	도성정밀	8.5*23.8			정승오금	
38	87.5*7*16.3	1	도성정밀	87.5*7*16.3			정승오금	
39	91*35*32,IMG(PS-424-PHV4)	1	도성정밀	91*35*32,IMG(PS-424-PHV4)			정승오금	H8006
40	DSC 20D-15	1	디에스씨전자(주)					RT8002
41	103K/250V/85℃ MT(5mm)	1	명성콘덴서(주)					C8117
42	103K/400V/85℃ MT(5mm)	1	명성콘덴서(주)					C8109
43	104K/250V/85℃ MT(5mm)	1	명성콘덴서(주)					C8001
44	104K/400V/85℃ MT(7.5mm)	1	명성콘덴서(주)					C8104
45	105J/630V/105℃ MP (27.5mm)	3	명성콘덴서(주)					C8008,87,88
46	225J/150V/105℃ MP (22.5mm)-M	1	명성콘덴서(주)					C8101

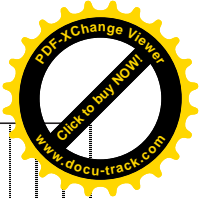

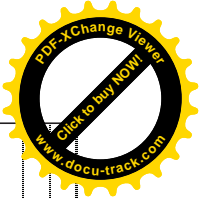
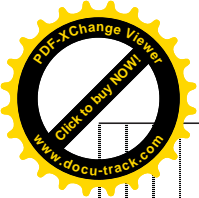

47	335J/150V/105℃ MP (22.5mm)-M	1	명성콘덴서(주)					C8100
48	473K/400V/85℃ MT(5mm)	2	명성콘덴서(주)					C8051,85
49	474J/630V/105℃ MP (22.5mm)-M	1	명성콘덴서(주)					C8009
50	10D/9	1	삼경세라믹					R18001
51	RD 1uF/50V/105℃(5*11)	1	삼화전기					C8025
52	RD 330uF/6.3V/105℃(6.3*11)	1	삼화전기					C8014
53	WB 680uF/50V/105℃(12.5*25)	5	삼화전기					C8037,42.53,54.91
54	WB1A338MT2025(3300uF/10V)	2	삼화전기					C8059,60
55	WL 33uF/450V/105℃(16*31.5)	1	삼화전기					C8028
56	WL 47uF/450V/105℃(18*31.5)	1	삼화전기					C8057
57	EK B 3A 101K 06 FK5(101K/1KV)	1	삼화콘덴서					C8041
58	EK B 3A 102K 08 FK5(102K/1KV)	1	삼화콘덴서					C8043
59	EK B 3A 221K 06 FK5(221K/1KV)	1	삼화콘덴서					C8239
60	EK B 3A 471K 06 FK5(471K/1KV)	1	삼화콘덴서					C8018
61	EK F 3A 103Z 10 FK5(103Z/1KV)	2	삼화콘덴서					C8012,40
62	SD B 2G 221K 08 FF1(221K/Y1)	1	삼화콘덴서					C8013
63	SD B 2G 471K 08 FF1(471K/Y1)	2	삼화콘덴서					C8002,11
64	X2 275AC 105M(436D)	2	선일전자산업(주)					C8004,5
65	X2 275AC 474K (436D)	1	선일전자산업(주)					C8003
66	104K 630V S 403 MPE	1	성호전자					C8228
67	ST-22	1	세기콘트롤					U8002
68	+PAN M3*P0.5-8.0L S/W P/W NI/P	20	시창구매					
69	M3*12L sems screw (F/S) NI-PLATE	6	시창구매					
70	TR(SMALL)	5	시창구매					
71	1K/5%/3W/R-FORMING	4	아벨전기					R8036,38,121,123
72	33Kohm/5%/3W/R-forming	2	아벨전기					R8035,126
73	56Kohm/5%/3W/M-forming	1	아벨전기					R8123
74	68Kohm/5%/1W	3	아벨전기					R8109,110,111
75	100Kohm/5%/1W/M/ABCO	2	아비코(주)					R8044,47
76	150Kohm/5%/3W	1	아비코(주)					R8127
77	2.2ohm/5%/1W	1	아비코(주)					R8313
78	2.4Mohm/5%/1W/R/ABCO	2	아비코(주)					R8235,267
79	200Kohm/5%/0.25W	10	아비코(주)					R8049,50,51,52,53,57,58,59,60,61
80	240Kohm/5%/3W/M/ABCO	1	아비코(주)					R8173
81	27Kohm/5%/3W/M/ABCO	1	아비코(주)					R8273
82	330Kohm/5%/0.5W/ABCO	3	아비코(주)					R8184,185,186
83	39Kohm/5%/2W/M-forming	2	아비코(주)					R8283,284
84	39Kohm/5%/3W/M/ABCO	1	아비코(주)					R8119
85	4.7ohm/5%/3W/M/ABCO	1	아비코(주)					R8002
86	470ohm/5%/3W/ABCO	1	아비코(주)					R8249
87	470ohm/5%/3W/R-forming	1	아비코(주)					R8250
88	6.8ohm/5%/1W/ABCO	2	아비코(주)					R8211,253
89	750ohm/5%/3W/M/ABCO	1	아비코(주)					R8120
90	90Kohm/5%/1W/R/ABCO	6	아비코(주)					R8131,172,197,296,297,298
91	ASR/1Mohm/5%/0.5W	1	아진 옴(A-JIN OHM)					R8006
92	ASR/220ohm/10%/0.5W	2	아진 옴(A-JIN OHM)					R8001,23
93	CRS511J/1206/0.25W	1	한룩전자(주)					R8159
94	CRS514J/1206/0.25W	1	한룩전자(주)					R8242
95	CRS561F/1206/0.25W	1	한룩전자(주)					R8282
96	CRS561J/1206/0.25W	1	한룩전자(주)					R8171

97	CRS681J/1206/0.25W	3	한록전자(주)					R8145,181,221
98	CRS682F/1206/0.25W	3	한록전자(주)					R8156,183,234
99	CRS682J/1206/0.25W	3	한록전자(주)					R8146,182,219
100	CRS683J/1206/0.25W	3	한록전자(주)					R8088,93,103
101	CRS684F/1206/0.25W	1	한록전자(주)					R8024
102	CRS752F/1206/0.25W	2	한록전자(주)					R8147,222
103	CRS754F/1206/0.25W	1	한록전자(주)					R8091
104	CRS911F/1206/0.25W	1	한록전자(주)					R8164
105	CRS914F/1206/0.25W	1	한록전자(주)					R8092
106	CRS914J/1206/0.25W	1	한록전자(주)					R8094
107	CRS0R0J/1206/0.25W	9	한록전자(주)					R8055,148,187,288,290, 291,292,293,294
108	CRS100J/1206/0.25W	2	한록전자(주)					R8073,144
109	CRS101J/1206/0.25W	6	한록전자(주)					R8070,149,177,220,239, 243
110	CRS102F/1206/0.25W	1	한록전자(주)					R8206
111	CRS102J/1206/0.25W	26	한록전자(주)					R8022,33,37,41,65,77,78, 85,104,140,153,155,162, 180,212,215,216,223,225, 227,237,244,254,257,265,300 R8021,73,76,89,96,98,161, 166,191,199,251,288,260,268
112	CRS103J/1206/0.25W	14	한록전자(주)					R8214
113	CRS104F/1206/0.25W	1	한록전자(주)					R8224
114	CRS104J/1206/0.25W	1	한록전자(주)					R8029,30,143
115	CRS122J/1206/0.25W	3	한록전자(주)					R8011,198,203
116	CRS124F/1206/0.25W	3	한록전자(주)					R8118
117	CRS133F/1206/0.25W	1	한록전자(주)					R8124,315
118	CRS151F/1206/0.25W	2	한록전자(주)					R8229
119	CRS152F/1206/0.25W	1	한록전자(주)					R8299
120	CRS153J/1206/0.25W	1	한록전자(주)					R8003,4,39,40,42,82
121	CRS154F/1206/0.25W	6	한록전자(주)					R8064
122	CRS154J/1206/0.25W	1	한록전자(주)					R8236,252
123	CRS182J/1206/0.25W	2	한록전자(주)					R8160,238
124	CRS183F/1206/0.25W	2	한록전자(주)					R8025
125	CRS184J/1206/0.25W	1	한록전자(주)					R8138
126	CRS184J/1206/0.25W	1	한록전자(주)					R8245
127	CRS1R0/1206/0.25W	1	한록전자(주)					R8301,2,3,4,5,6,7,8,9,10,11,12
128	CRS200F/1206/0.25W	12	한록전자(주)					R8129,201
129	CRS201J/1206/0.25W	2	한록전자(주)					R8154
130	CRS202F/1206/0.25W	1	한록전자(주)					R8014,231
131	CRS202J/1206/0.25W	2	한록전자(주)					R8027,87,135,174,176,179, 218,228,286,287
132	CRS204F/1206/0.25W	10	한록전자(주)					R8208,264
133	CRS204J/1206/0.25W/HANRYUK	2	한록전자(주)					R8217
134	CRS221J/1206/0.25W	1	한록전자(주)					R8032,34,101,116,136,151, 178,204
135	CRS222J/1206/0.25W	8	한록전자(주)					R8026
136	CRS223F/1206/0.25W	1	한록전자(주)					R8117
137	CRS223J/1206/0.25W	1	한록전자(주)					R8200
138	CRS224F/1206/0.25W	1	한록전자(주)					R8071,99
139	CRS242F/1206/0.25W	2	한록전자(주)					R8100
140	CRS243F/1206/0.25W	1	한록전자(주)					R8079,81
141	CRS244F/1206/0.25W	2	한록전자(주)					R8192
142	CRS270J/1206/0.25W	1	한록전자(주)					R8195
143	CRS271J/1206/0.25W/HANRYUK	1	한록전자(주)					

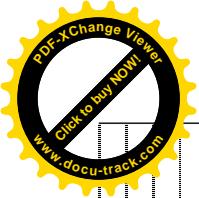

144	CRS272J/1206/0.25W	1	한록전자(주)				R8107
145	CRS273J/1206/0.25W	2	한록전자(주)				R8132,205
146	CRS274F/1206/0.25W	5	한록전자(주)				R8010,16,18,285,130
147	CRS274J/1206/0.25W	1	한록전자(주)				R8168
148	CRS302F/1206/0.25W	4	한록전자(주)				R8165,262,295,157
149	CRS302J/1206/0.25W	1	한록전자(주)				R8213
150	CRS303F/1206/0.25W	1	한록전자(주)				R8114
151	CRS304F/1206/0.25W	5	한록전자(주)				R8005,8,9,15,210
152	CRS330J/1206/0.25W	5	한록전자(주)				R8141,246,247,248,279
153	CRS332J/1206/0.25W	2	한록전자(주)				R8139,190
154	CRS333F/1206/0.25W	2	한록전자(주)				R8043,142
155	CRS333J/1206/0.25W	3	한록전자(주)				R8133,240,241
156	CRS391F/1206/0.25W	1	한록전자(주)				R8314
157	CRS391J/1206/0.25W	1	한록전자(주)				R8152
158	CRS431J/1206/0.25W	2	한록전자(주)				R8128,263
159	CRS470J/1206/0.25W	8	한록전자(주)				R8080,134,175,202,270,275,276,277
160	CRS471J/1206/0.25W	5	한록전자(주)				R8020,31,108,122,209
161	CRS472F/1206/0.25W	3	한록전자(주)				R8083,115,274
162	CRS472J/1206/0.25W	7	한록전자(주)				R8045,97,106,113,163,256,266
163	CRS473J/1206/0.25W	3	한록전자(주)				R8169,278,316
164	CRS477J/1206/0.25W	1	한록전자(주)				R8269
165	CRS512F/1206/0.25W	1	한록전자(주)				R8017
166	CRS562J/1206/0.25W/HANRYUK	6	한록전자(주)				R8048,72,86,102,105,233
167	JRW1N0R54J	2	한미정밀전자				R8226,230
168	JRW1N1R0J	1	한미정밀전자				R8150
169	JRW1N2R2J	1	한미정밀전자				R8095
170	MPR-05RS 0.01ohm/5%	2	한미정밀전자				R8019,194
171	MPR-05RS 0.3ohm/5%	2	한미정밀전자				R8158,167
172	RQR-05 5.1KJ	1	한미정밀전자				R8272
173	AME8811AETZ	1	AME				IC8012
174	TO-3PH-S9	1	APEX				
175	AZ431LAZ-E1	1	BCD				IC8023
176	2SPRE 10K	6	BI				VR8002,5,6,7,8,9
177	3-1944 RTV	5	DOWCORNING				
178	SE-4490CV	1	DOWCORNING				
179	FQA24N60	2	FAIRCHILD				Q8020,22
180	2SK3532-01MR	1	FUJI				Q8008
181	2SK3679-01MR	2	FUJI				Q8015,16
182	F9222L	1	FUJI				IC8028
183	IXFH26N60Q	2	IXYS CORPORATION				Q8001,3
184	NUM2903M	1	J.R.C				U8003
185	NUM2904M	1	J.R.C				U8005
186	B10B-PH-K-S	1	JST				CN1M03
187	B11B-PH-K-S	1	JST				CN1M46
188	B2P3-VH	1	JST				CN8001
189	B4B-PH-K-S	1	JST				CN1M10
190	B7B-PH-K-S	1	JST				CN1M02
191	KIA7815	2	KEC				IC8034,220
192	KIA7818	1	KEC				IC8007
193	KA1273-Y	1	KEC				Q8004
194	KA1281-Y	6	KEC				Q8007,10,11,202,203,207

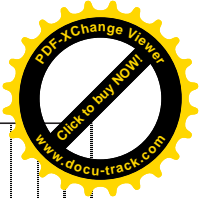

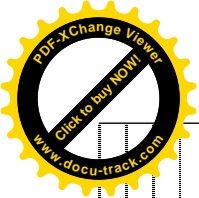

195	KTB1151		1	KEC				Q8013
196	KT C3205-Y		1	KEC				Q8002
197	KT C3209-Y		4	KEC				Q8005,6,201,205
198	KT N2222AS		5	KEC				Q8009,14,17,18,221
199	KT N2907AS		1	KEC				Q8012
200	GSHS-1625(P8-17mm) Transparency		1	LG CABLE(ㄱ)				
201	215 001(250V/1A)		1	Litelfuse				F8002
202	215 002(250V/2A)		1	Litelfuse				F8005
203	215 004(250V/4A)		1	Litelfuse				F8007
204	215 008(250V/8A)		1	Litelfuse				F8001
205	263 001(250V/1A)		1	Litelfuse				F8004
206	FB58(20mm)		4	Litelfuse				F8001,2,5,7
207	V20E420		1	Litelfuse				SA8001
208	GF 100uF/25V/105℃(6.3*11)		1	MANYUE				C8082
209	GF 100uF/35V/105℃(8*12)		3	MANYUE				C8019,111,227
210	GF 100uF/50V/105℃(10*12.5)		2	MANYUE				C8069,149
211	GF 10uF/50V/105℃(6*11)		4	MANYUE				C8029,71,96,124
212	GF 4.7uF/50V/105℃(5*11)		1	MANYUE				C8035
213	GF 47uF/35V/105℃(6.3*11)		3	MANYUE				C8006,34,113
214	HP 330uF/450V/105℃(35*40)		2	MANYUE				C8007,10
215	HP 680uF/315V/105℃(30*40)		2	MANYUE				C8098,99
216	KM 1000uF/10V/105℃(10*12.5)		2	MANYUE				C8045,48
217	KM 1000uF/16V/105℃(10*16)		1	MANYUE				C8077
218	KM 1000uF/25V/105℃(10*20)		1	MANYUE				C8055
219	KM 100uF/160V/105℃(12.5*25)		1	MANYUE				C8106
220	KM 2200uF/10V/105℃(10*20)		4	MANYUE				C8026,46,49,143
221	KM 22uF/100V/105℃(6.3*11)		1	MANYUE				C8039
222	KM 4.7uF/25V/105℃(5*11)		1	MANYUE				C8083
223	KM 470uF/25V/105℃(10*12.5)		5	MANYUE				C8052,56,68,92,93
224	KM 470uF/50V/105℃(10*20)		3	MANYUE				C8044,47,78
225	KM 47uF/350V/105℃(16*25)		2	MANYUE				C8050,84
226	KM 47uF/50V/105℃(6.3*11)		2	MANYUE				C8222,224
227	KM 680uF/100V/105℃(16*31.5)		3	MANYUE				C8105,108,231
228	MEG07NR68JB133		1	MICRON				R8012
229	DSP-501-N		2	MITSUBISHI				RA8001,2
230	35312-1060		1	MOLEX				CN8006
231	35313-0560		2	MOLEX				CN8004,5
232	35313-0960		1	MOLEX				CN8002
233	35313-1060		1	MOLEX				CN8003
234	FCU20A40		2	N.I				D8046,48
235	FSF10A20		1	N.I				D8047
236	FSF10A40		2	N.I				D8033,41
237	HC630V223J		1	OKAYA				C8097
238	1N5408-M		1	ON SEMI				D8001
239	LM2576TV-5G		2	ON SEMI				IC8013,14
240	LM2576TV-ADUG		2	ON SEMI				IC8026,41
241	MMSZ5227BT1G(3.6V)		9	ON SEMI				ZD8225,226,227,228,229,230,231,233,235
242	MMSZ5231BT1G(5.1V)		1	ON SEMI				ZD8003
243	MMSZ5235BT1G(6.8V)		1	ON SEMI				ZD8223
244	MMSZ5241BT1G(11V)		2	ON SEMI				ZD8101,102
245	MMSZ5245BT1G(15V)		3	ON SEMI				ZD8004,5,205

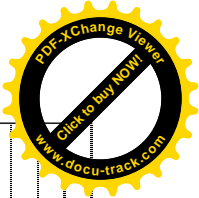

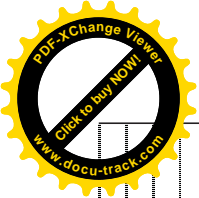

246	MMSZ5254BT1G(27V)	2	ON SEMI						ZD8100,222
247	NCP1200AP100G	1	ON SEMI						IC8003
248	NCP1207P	2	ON SEMI						IC8016,17
249	PH01-02SSG	2	PLASTRON						J8003,4
250	RS3506M	1	RECTRON						D8006
251	SF304C	1	RECTRON						D8037
252	1N4148	3	ROHM						D8039,44,54
253	STR-G6353	3	SANKEN						IC8015,24,29
254	D1FL20U	6	SHINDENGEN						D8016,18,57,100,220,221
255	D1FS4	8	SHINDENGEN						D8007,8,12,20,55,58,59,60
256	D1FS6	1	SHINDENGEN						D8050
257	STTH12R06FP	1	ST MICRO-ELECTRONICS						D8002
258	STP80PF55	1	ST MICRO-ELECTRONICS						Q8220
259	STTH12R06FP	1	ST MICRO-ELECTRONICS						D8003
260	STTH15R06FP	1	ST MICRO-ELECTRONICS						D8004
261	STTH2003CFP	4	ST MICRO-ELECTRONICS						D8026,30,45,53
262	1N4747A	2	TAK CHEONG						ZD8220,221
263	1N4750A(27V/1W)	7	TAK CHEONG						ZD8201,202,203,204,232,234,236
264	1N4750A(27V/1W)	3	TAK CHEONG						ZD8001,2,200
265	101J/0805/NPO/50V/TD	1	TDK						C8074
266	102J/0805/NPO/50V/TD	3	TDK						C8030,80,148
267	103K/0805/XTR/50V/TD	5	TDK						C8027,112,221,229,235
268	104K/0805/XTR/50V/TD	23	TDK						C8015,21,32,58,63,64,76,82,89,102,103,107,122,118,120,121,146,147,220,223,230,233,236
269	105K/0805/XTR/25V/TD	5	TDK						C8150,228,228,232,237
270	221J/0805/NPO/50V/TD	6	TDK						C8070,95,123,240,241,242
271	224K/0805/XTR/50V/TD	4	TDK						C8065,090,119,238
272	471J/0805/NPO/50V/TD	6	TDK						C8031,73,75,79,81,234
273	472K/0805/XTR/50V/TD	1	TDK						C8116
274	473K/0805/XTR/50V/TD	3	TDK						C8110,125,127
275	474K/0805/XTR/25V/TD	1	TDK						C8067
276	CV108200S	2	TNC						L8005,6
277	SDT-S-105DMR	2	TYCO ELECTRONICS H.K.LTD.						RLY8001,2
278	1N4007	8	VISHAY						D8009,10,11,13,14,15,24,25
279	1N4007	1	VISHAY						D8061
280	BYV26C	1	VISHAY						D8052
281	BYV26EGP	2	VISHAY						D8035,42
282	MBRF1560CT	1	VISHAY						D8040
283	SB140	4	VISHAY						D8043,49,62,203
284	SB540	2	VISHAY						D8034,56
285	SB560	2	VISHAY						D8019,31
286	TCET1103	15	VISHAY						IC8001,4,5,8,9,10,18,20,22,25,30,31,32,37,300
287	TCET1109	1	VISHAY						IC8011
288	UF4007	4	VISHAY						D8029,32,36,38
289	UF4007	4	VISHAY						D8005,17,23,27
290	382 1100 (AC250V T1AL)	2	WICKMANN						F8008,9
291	382 1315 (AC250V T3.15AL)	2	WICKMANN						F8003,6

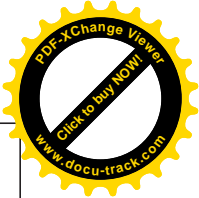

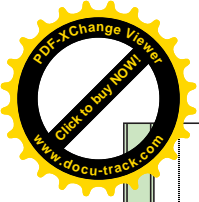

2.ALARM

순번	자품목규격	소요량	제조사	대체품규격	대체품제조사	대체품규격	대체품제조사	지제위치
1	SM1316	1	광전자	72*32*1.0t (PHV4 MICOM/Rev0.65)		72*32*1.0t (PHV4 MICOM/Rev0.65)		BD8903
2	72*32*1.0t (PHV4 MICOM/Rev0.65)	1	대진전자		다빈전자			
3	RC 10uF/35V/105 C(5*5.3)	2	삼화전기				한우산업(주)	BC8901.903
4	ORQJ/0805/0.1W/HANRYUK	2	한록전자(주)					BR8906.907
5	102J/0805/0.1W/HANRYUK	4	한록전자(주)					BR8903.19.24.27
6	103J/0805/0.1W/HANRYUK	5	한록전자(주)					BR8241.243.904.905.915
7	104J/0805/0.1W/HANRYUK	1	한록전자(주)					BR8901
8	153J/0805/0.1W/HANRYUK	1	한록전자(주)					BR8910
9	183J/0805/0.1W/HANRYUK	1	한록전자(주)					BR8926
10	223J/0805/0.1W/HANRYUK	1	한록전자(주)					BR8930
11	243J/0805/0.1W/HANRYUK	1	한록전자(주)					BR8931
12	274J/0805/0.1W/HANRYUK	3	한록전자(주)					BR8913.16.20
13	332J/0805/0.1W/HANRYUK	1	한록전자(주)					BR8925
14	362J/0805/0.1W/HANRYUK	1	한록전자(주)					BR8928
15	392J/0805/0.1W/HANRYUK	2	한록전자(주)					BR8911.29
16	393J/0805/0.1W/HANRYUK	2	한록전자(주)					BR8914.32
17	471J/0805/0.1W/HANRYUK	5	한록전자(주)					BR8242.912.918.922.923
18	472J/0805/0.1W/HANRYUK	3	한록전자(주)					BR8934.36.37
19	752J/0805/0.1W/HANRYUK	1	한록전자(주)					BR8909
20	912J/0805/0.1W/HANRYUK	2	한록전자(주)					BR8908.38
21	NUM2370U05	1	J.R. C					BU8902
22	KDS184	6	KEC					BD8901.2,4,5,6,7
23	KTN2222AS	2	KEC					BQ8240.902
24	KTN2907AS	1	KEC					BQ8901
25	53261-0690	1	MOLEX					CON8901
26	MMSZ5235BT1G(6.8V)	1	ON SEMI					BZD8901
27	MMSZ5242BT1G(12V)	1	ON SEMI					BZD8902
28	PH01-02SSG	2	PLASTRON					BI8901.2
29	PH01-24SRU	1	PLASTRON					CON8902
30	ST72F324K2T6	1	ST MICRO-ELECTRONICS					BU8901
31	104K/0805/XTR/50V/TD	19	TDK					BC8240.902.904.905.906, 907.908.909.910.911.912, 913.914.915.916.917.918, 919.920

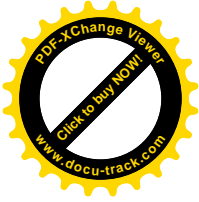

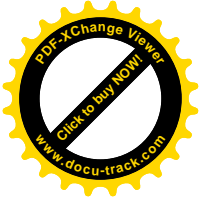
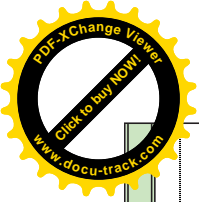

3.PFC

순번	자품목규격	소요량	제조사	대체품규격	대체품제조사	대체품규격	대체품제조사	지재위치
1	PH01-16-SRU	1	(주)테준전자					CN8008
2	TL431ASF	1	(주)네진기술					U8320
3	40.5*30*1.0 (PHV4 PFC/Rev0.65)	1	대진전자	40.5*30*1.0 (PHV4 PFC/Rev0.65)	대진전자	40.5*30*1.0 (PHV4 PFC/Rev0.65)	현우산업(주)	
4	RC 1.0uF/50V/105℃(4*5.3)	1	심화전기					C8312
5	RC 22uF/25V/105℃(6.3*5.3)	1	심화전기					C8301
6	CRS103J/1206/0.25W	1	한록전자(주)					R8321
7	CRS152J/1206/0.25W	1	한록전자(주)					R8305
8	CRS203F/1206/0.25W	2	한록전자(주)					R8322,323
9	CRS223F/1206/0.25W	1	한록전자(주)					R8308
10	CRS224F/1206/0.25W	1	한록전자(주)					R8304
11	CRS273F/1206/0.25W	1	한록전자(주)					R8302
12	CRS512F/1206/0.25W	1	한록전자(주)					R8303
13	CRS824J/1206/0.25W	1	한록전자(주)					R8320
14	CRS912F/1206/0.25W	2	한록전자(주)					R8300,001
15	CRS913F/1206/0.25W	1	한록전자(주)					R8307
16	NUM2903M	1	J.R.C					U8301
17	L4981AD	1	ST MICRO-ELECTRONICS					U8300
18	102K/0805/XTR/50V/TDK	3	TDK					C8302,303,307
19	103K/0805/XTR/50V/TD	1	TDK					C8320
20	104K/0805/XTR/50V/TD	2	TDK					C8304,309
21	105K/0805/XTR/25V/TD	1	TDK					C8300,311
22	224K/0805/XTR/50V/TD	1	TDK					C8305
23	474K/0805/XTR/25V/TD	1	TDK					C8310



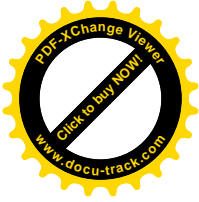
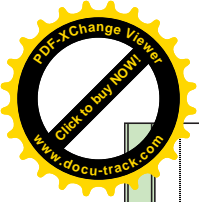

4.VS

순번	자품목규격	소요량	제조사	대체품규격	대체품제조사	대체품규격	대체품제조사	지재위치
1	39*34.5*1.0t (PHV4 VS/Rev0.65)	1	대진전자	39*34.5*1.0t (PHV4 VS/Rev0.65)	다빈전자	39*34.5*1.0t (PHV4 VS/Rev0.65)	원두산업(주)	C8211
2	RC 10uF/50V/105 C(6.3*5.3)	1	삼화전기					R8281,282
3	CRS0R0J/1206(0.25W)	2	한록전자(주)					R8255
4	CRS101J/1206(0.25W)	1	한록전자(주)					R8235,243
5	CRS102J/1206(0.25W)	2	한록전자(주)					R8250
6	CRS103J/1206(0.25W)	1	한록전자(주)					R8248,280
7	CRS124J/1206(0.25W)	2	한록전자(주)					R8246
8	CRS152J/1206(0.25W)	1	한록전자(주)					R8258
9	CRS153J/1206(0.25W)	1	한록전자(주)					R8249
10	CRS222J/1206(0.25W)	1	한록전자(주)					R8245
11	CRS242J/1206(0.25W)	1	한록전자(주)					R8239
12	CRS302J/1206(0.25W)	1	한록전자(주)					R8279
13	CRS332J/1206(0.25W)	1	한록전자(주)					R8251
14	CRS333F/1206(0.25W)	1	한록전자(주)					R8256
15	CRS394J/1206(0.25W)	1	한록전자(주)					R8247,257
16	CRS473J/1206(0.25W)	2	한록전자(주)					R8252
17	CRS822J/1206(0.25W)	1	한록전자(주)					C8218
18	202K/0805/XTR/50V/AV	1	AVX					C8204
19	KTN222AS	1	KEC					IC8200
20	MC14093BD	1	ON SEMI					CN8333
21	PH01-11SRU	1	PLASTRON					IC8201
22	TL494CDR	1	T.I					C8207,212,219,220,221
23	103K/0805/XTR/50V/TD	5	TDK					C8205,208
24	104K/0805/XTR/50V/TD	2	TDK					C8129,206,209,214
25	105K/0805/XTR/25V/TD	4	TDK					C8213,217
26	221J/0805/NPO/50V/TD	2	TDK					

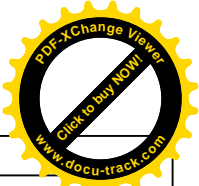
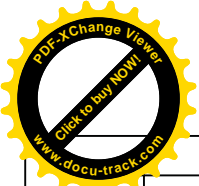

NO	PART NAME	Q'TY	MATERIAL	PRODUCT SIZE	FINISH
1	HEAT SINK	1	A6063S-T5	15*11*30	초음파 탈지
2	SOLDER PIN	2	C2602 1/2H		Sn

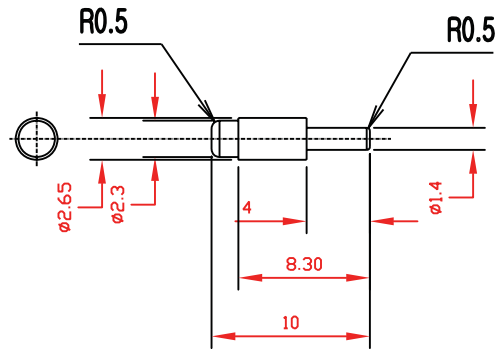
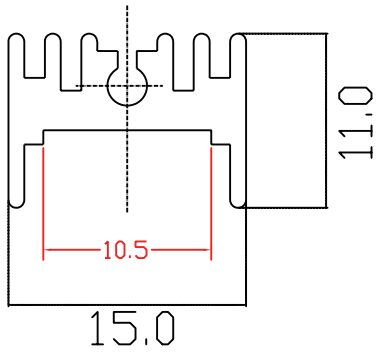

SOLDER PIN S:2/1

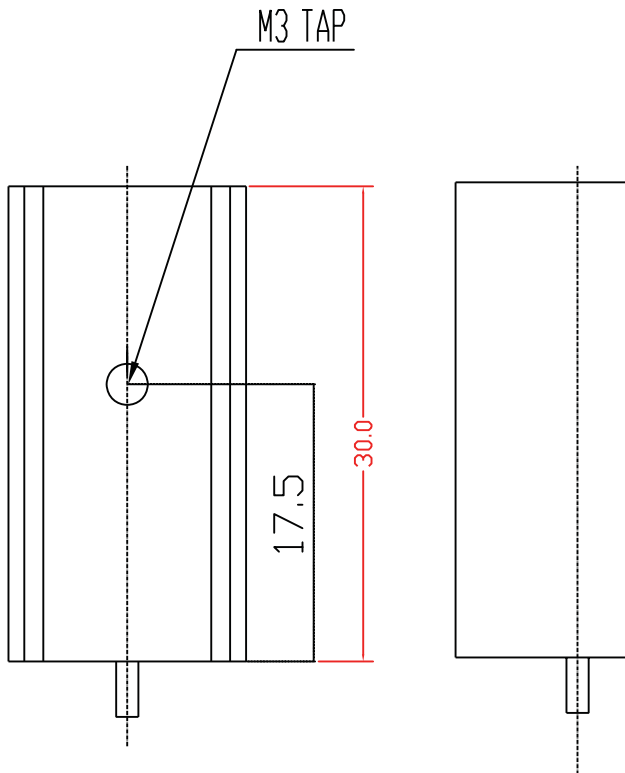

NOTE

1. SOLDER PIN 압입후 흔들림이 없을것.
2. TAP 가공상태가 양호할것.

DATE		REVISION RECORD		WRITTEN BY		CHECKED BY	REMARKS
TOLERANCE	SCALE	DRAW	DESIGED	CHECKED	APPROVED	PART NAME	HEAT SINK
±0.3	2/1	윤준구				MODEL	H8008,9,10,11
DOSUNG PRECISION						E-CODE	E703203040-L

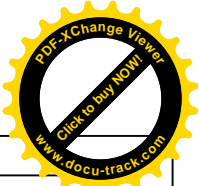
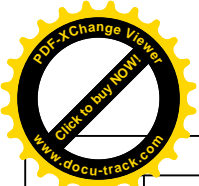

NO	PART NAME	Q'TY	MATERIAL	PRODUCT SIZE	FINISH
1	HEAT SINK	1	A6063S-T5	156*35*32	WHITE ANODIZING
2	단자	2	SPC		Sn

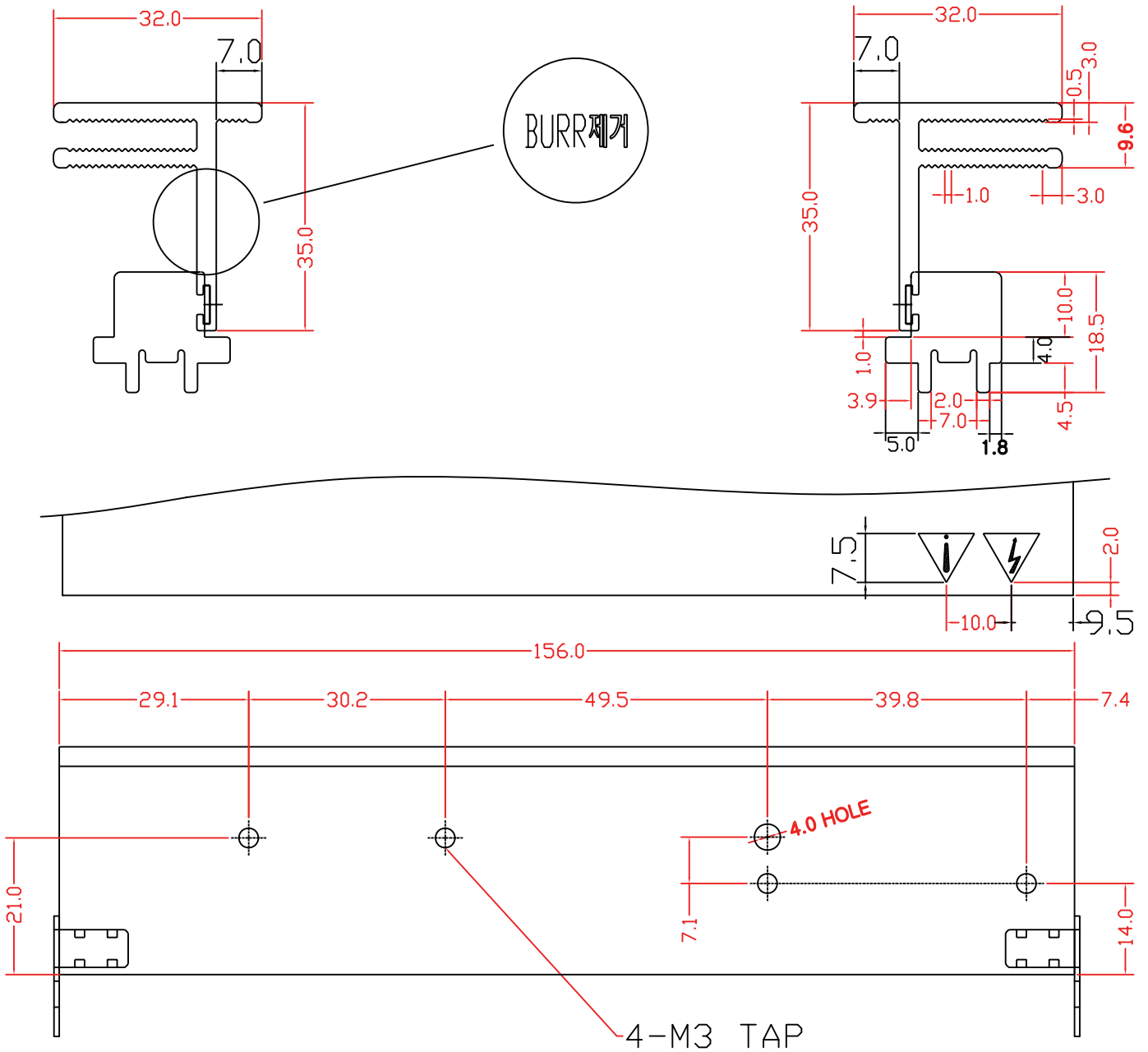

DATE	REVISION RECORD			WRITTEN BY		CHECKED BY	REMARKS
TOLERANCE	SCALE	DRAW	DESIGED	CHECKED	APPROVED	PART NAME	HEAT SINK
±0.3	1/1	윤영구				MODEL	H8007
DOSUNG PRECISION						E-CODE	E703203010-L

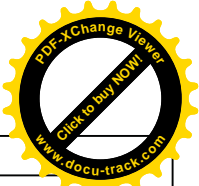
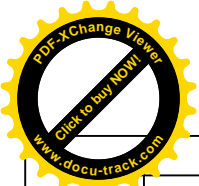

NO	PART NAME	Q'TY	MATERIAL	PRODUCT SIZE	FINISH
1	HEAT SINK	1	A6063S-T5	91*35*32	WHITE ANODIZING
2	단자	2	SPC		Sn

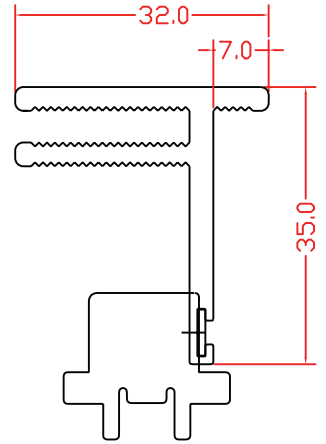
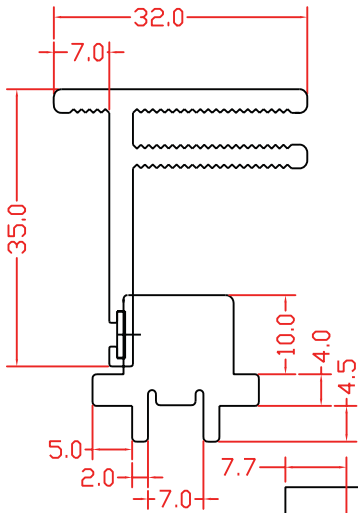

42인치 각인표시 □ 30 X 19  
(글씨체:돋움체)

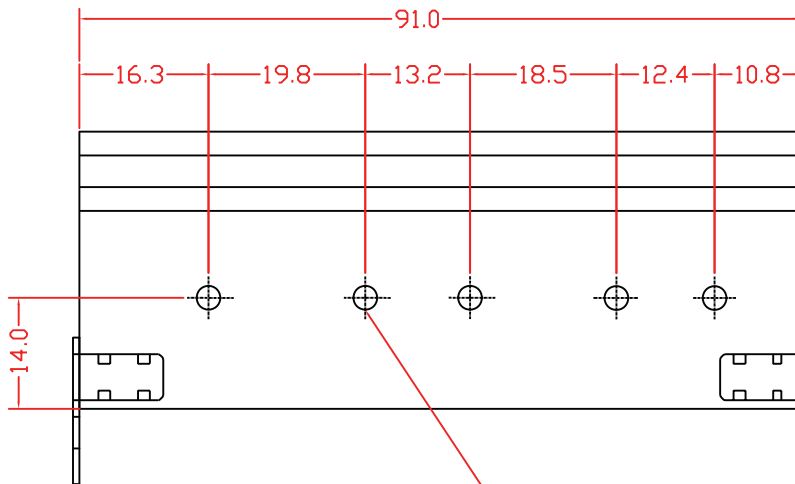
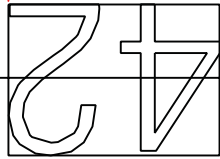

5-M3 TAP

DATE		REVISION RECORD		WRITTEN BY		CHECKED BY	REMARKS
TOLERANCE	SCALE	DRAW	DESIGED	CHECKED	APPROVED	PART NAME	HEAT SINK
±0.3	2/1	윤원구				MODEL	H8006
DOSUNG PRECISION						E-CODE	E703202980-L

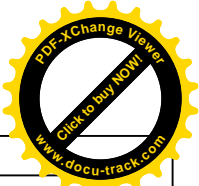
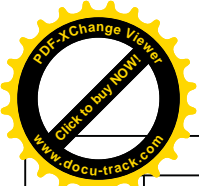

NO	PART NAME	Q'TY	MATERIAL	PRODUCT SIZE	FINISH
1	HEAT SINK	1	A6063S-T5	116*35*32	WHITE ANODIZING
2	단자	2	SPC		Sn

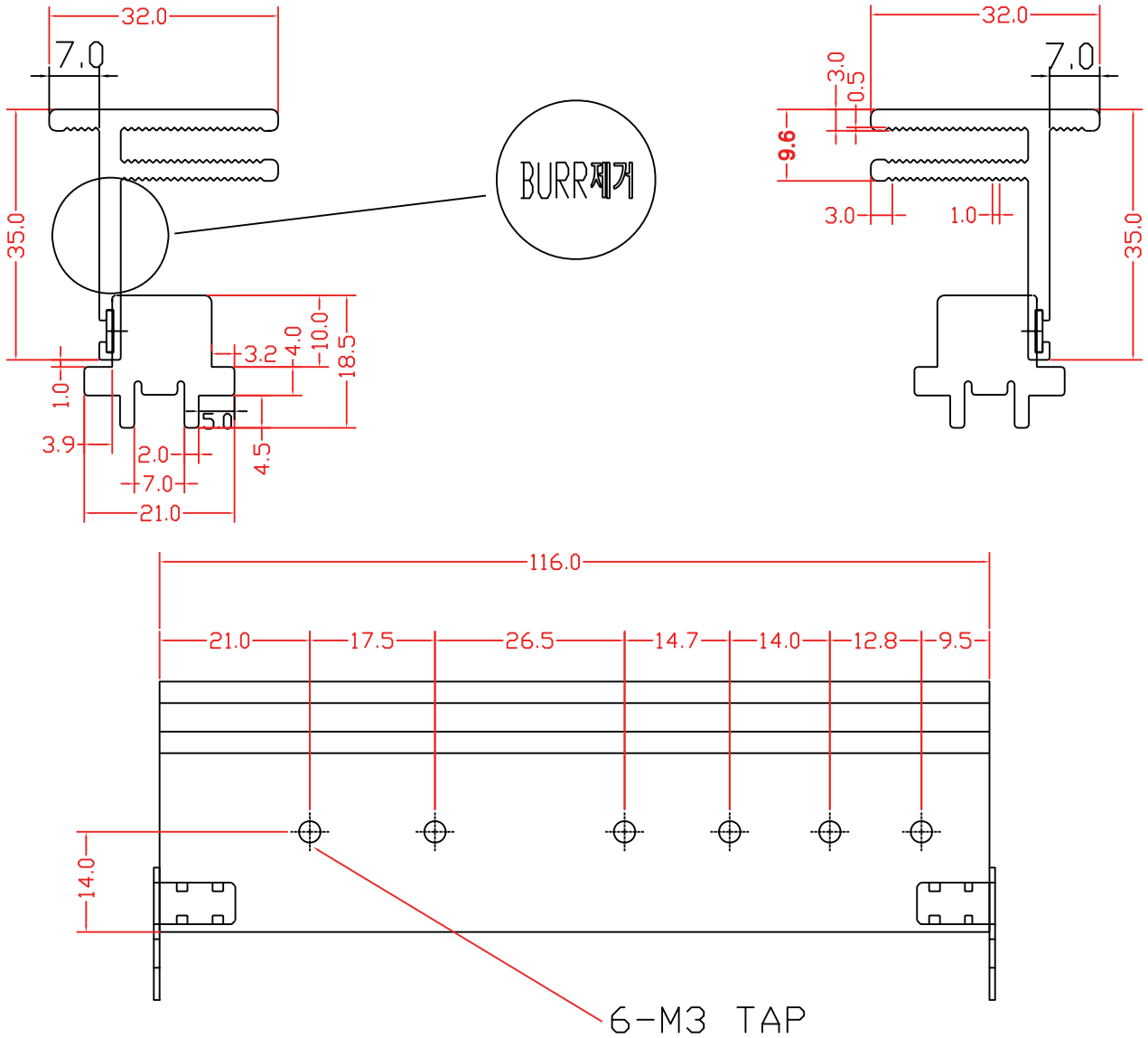

DATE	REVISION RECORD			WRITTEN BY		CHECKED BY	REMARKS
TOLERANCE	SCALE	DRAW	DESIGED	CHECKED	APPROVED	PART NAME	HEAT SINK
±0.3	1/1	윤원구				MODEL	H8005
DOSUNG PRECISION						E-CODE	E703202950-L

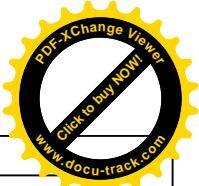
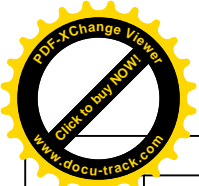

NO	PART NAME	Q'TY	MATERIAL	PRODUCT SIZE	FINISH
1	HEAT SINK	1	A6063S-T5	61*35*32	WHITE ANODIZING
2	단자	2	SPC		Sn

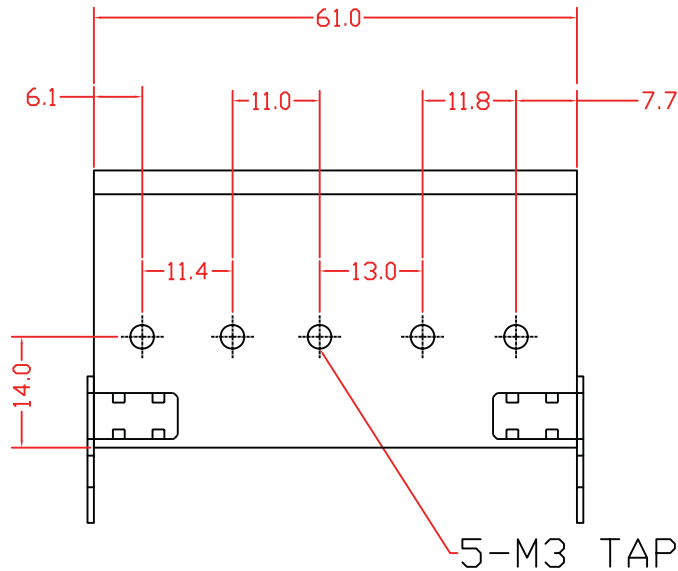
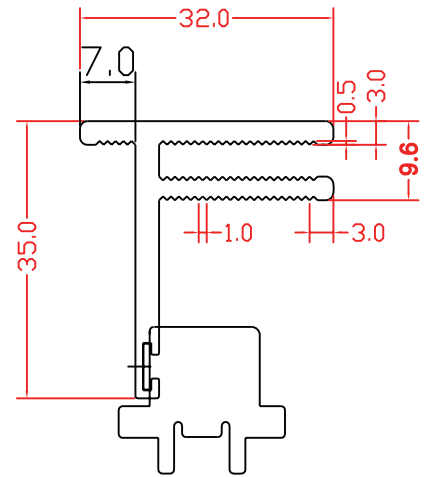
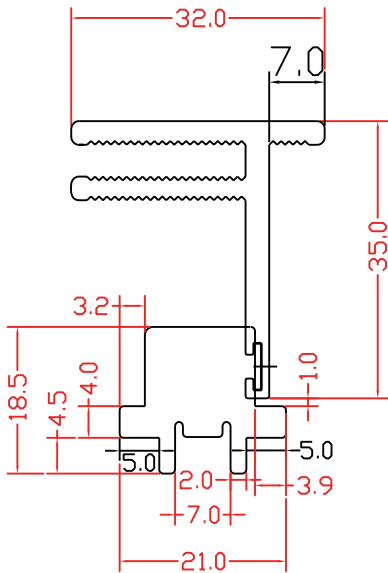

DATE		REVISION RECORD		WRITTEN BY		CHECKED BY	REMARKS
TOLERANCE	SCALE	DRAW	DESIGED	CHECKED	APPROVED	PART NAME	HEAT SINK
±0.3	1/1	윤원규				MODEL	H8004
DOSUNG PRECISION						E-CODE	E703202920-L

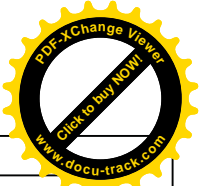
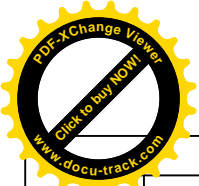

NO	PART NAME	Q'TY	MATERIAL	PRODUCT SIZE	FINISH
1	HEAT SINK	1	A6063S-T5	156.1*35*32	WHITE ANODIZING
2	단자	2	SPC		Sn

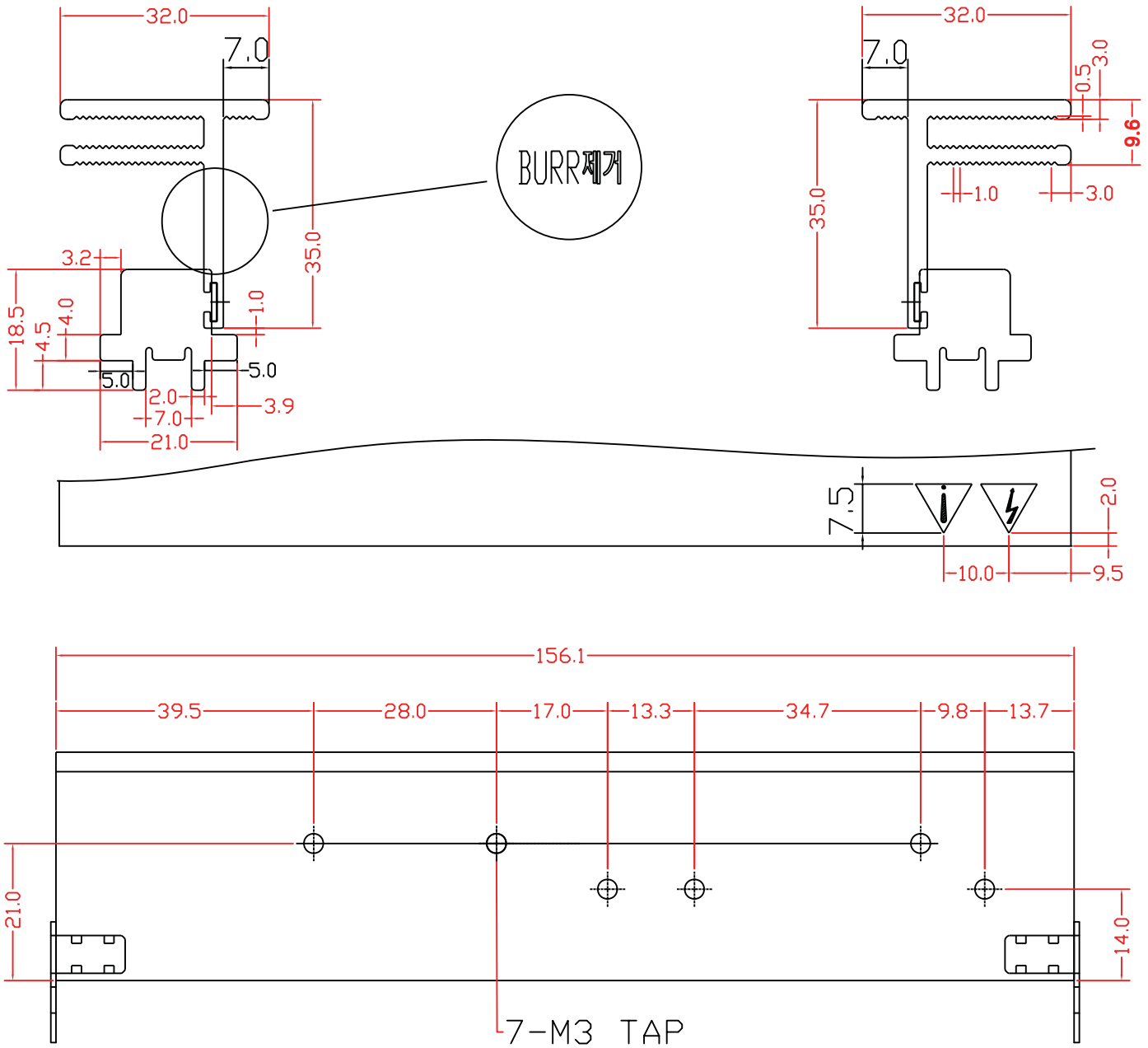

DATE		REVISION RECORD		WRITTEN BY		CHECKED BY	REMARKS
TOLERANCE	SCALE	DRAW	DESIGED	CHECKED	APPROVED	PART NAME	HEAT SINK
±0.3	1/1	윤원구				MODEL	H8002
DOSUNG PRECISION						E-CODE	E703202890-L

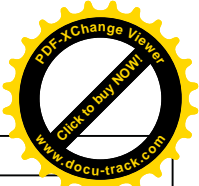
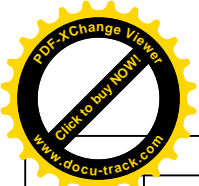

NO	PART NAME	Q'TY	MATERIAL	PRODUCT SIZE	FINISH
1	HEAT SINK	1	A6063S-T5	131*35*32	WHITE ANODIZING
2	단자	2	SPC		Sn

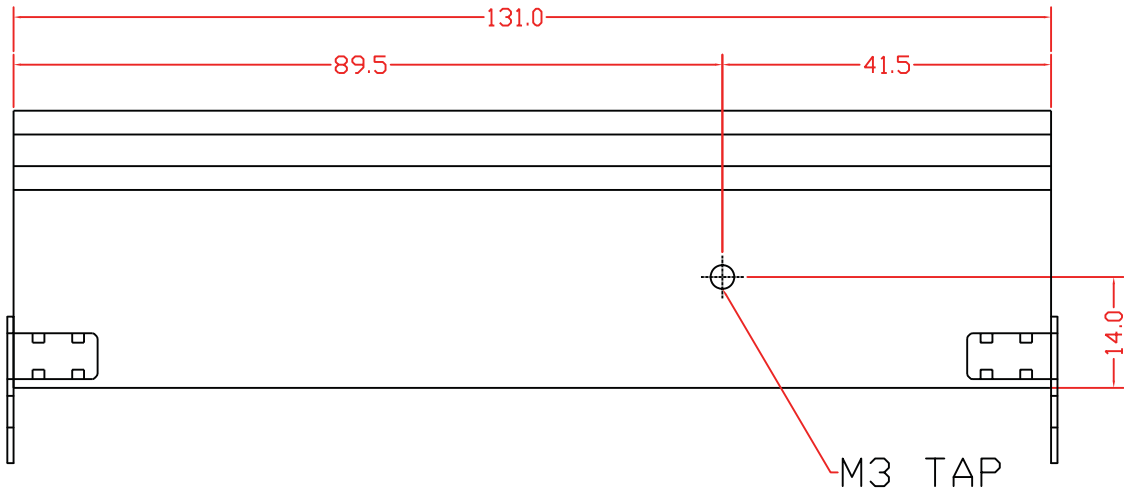
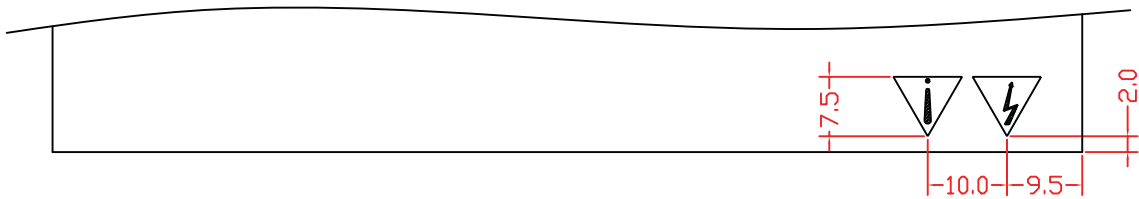
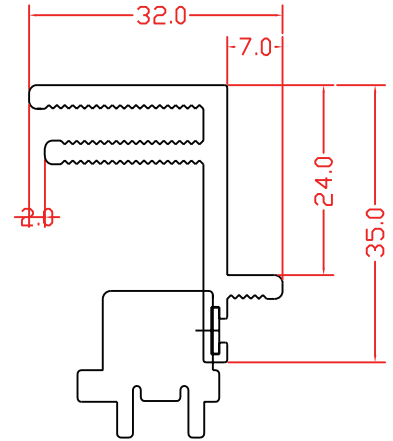
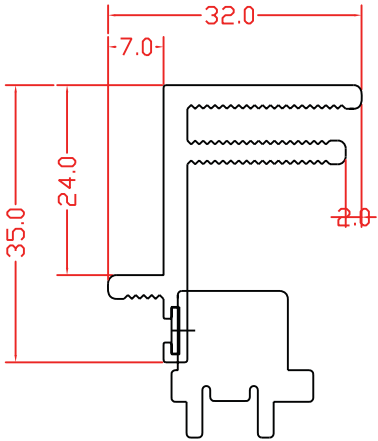

DATE	REVISION RECORD			WRITTEN BY		CHECKED BY	REMARKS
TOLERANCE	SCALE	DRAW	DESIGED	CHECKED	APPROVED	PART NAME	HEAT SINK
±0.3	1/1	윤원구				MODEL	H8001
DOSUNG PRECISION						E-CODE	E703203190-L



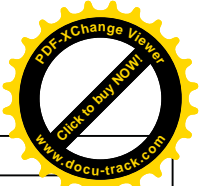
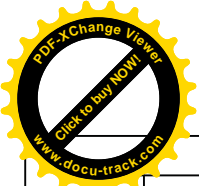

NO	PART NAME	Q'TY	MATERIAL	PRODUCT SIZE	FINISH
1	HEAT SINK	1	A6063S-T5	15*11*25	초음파 탈지
2	SOLDER PIN	2	C2602 1/2H		Sn

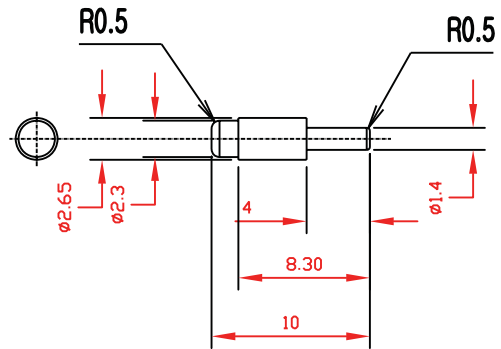
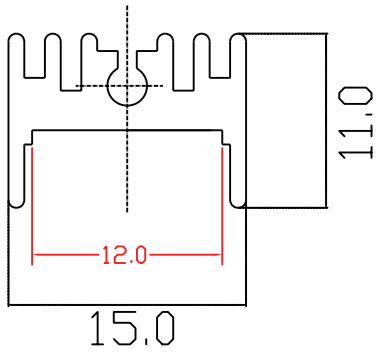

SOLDER PIN S:2/1

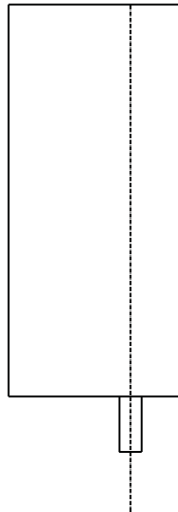
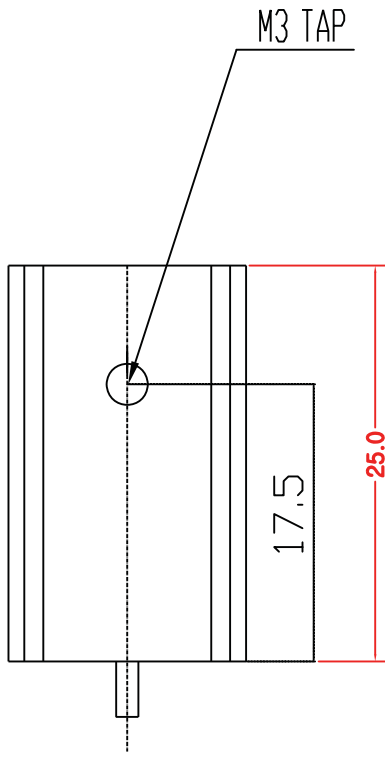

NOTE

1. SOLDER PIN 압입후 흔들림이 없을것.
2. TAP 가공상태가 양호할것.

DATE	REVISION RECORD			WRITTEN BY		CHECKED BY	REMARKS
TOLERANCE	SCALE	DRAW	DESIGED	CHECKED	APPROVED	PART NAME	HEAT SINK
±0.3	2/1	윤원구				MODEL	H8012
DOSUNG PRECISION						E-CODE	E703203070-L

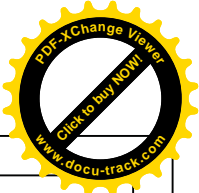
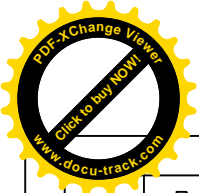

NO	PART NAME	Q'TY	MATERIAL	PRODUCT SIZE	FINISH
1	HEAT SINK	1	A6063S-T5	87.5*7*16.3	초음파 탈지

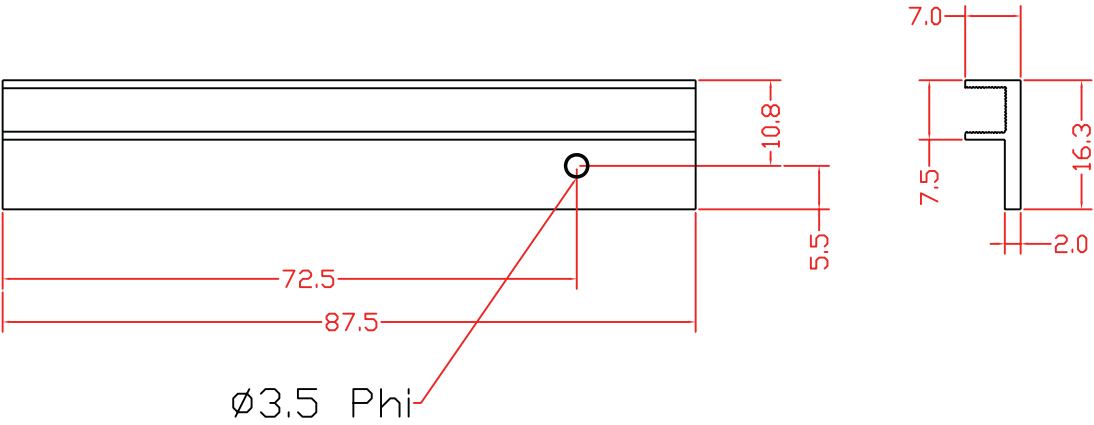

DATE	REVISION RECORD			WRITTEN BY		CHECKED BY	REMARKS
TOLERANCE	SCALE	DRAW	DESIGED	CHECKED	APPROVED	PART NAME	HEAT SINK
$\pm 0.3$	1/1	윤원구				MODEL	CLAMP
DOSUNG PRECISION						E-CODE	E90908164-L

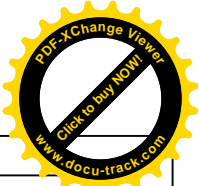
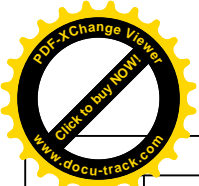

NO	PART NAME	Q'TY	MATERIAL	PRODUCT SIZE	FINISH
1	CLIP	1	SUS 301 3/4	8.5*23.8	초음파 탈지

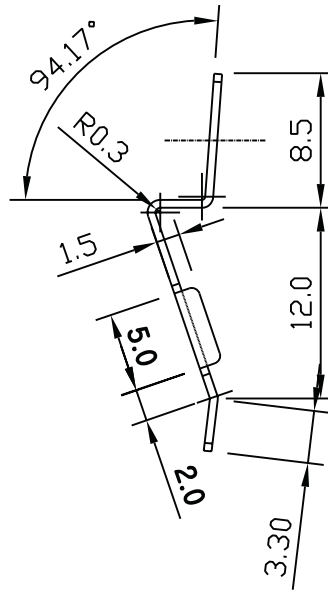
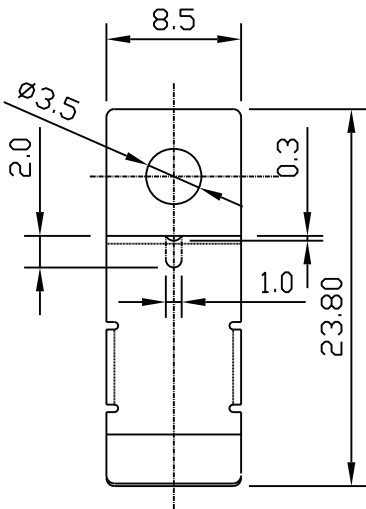
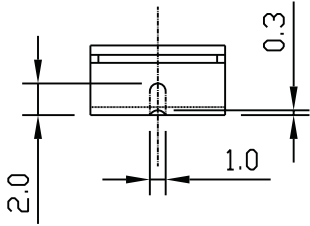

DATE	REVISION RECORD			WRITTEN BY		CHECKED BY	REMARKS
TOLERANCE	SCALE	DRAW	DESIGED	CHECKED	APPROVED	PART NAME	HEATSINK
±0.3	2/1	윤영규				MODEL	CLAMP
DOSUNG PRECISION						E-CODE	E90908152-L

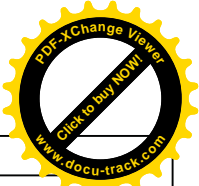
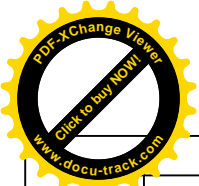

NO	PART NAME	Q'TY	MATERIAL	PRODUCT SIZE	FINISH
1	CLAMP	1	A1050P 1/2H	2.0t*22*8	

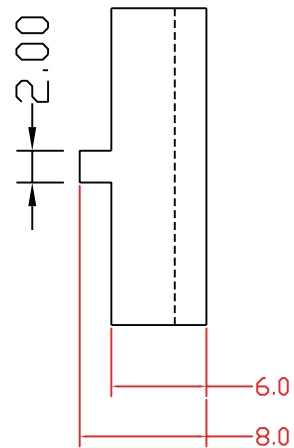
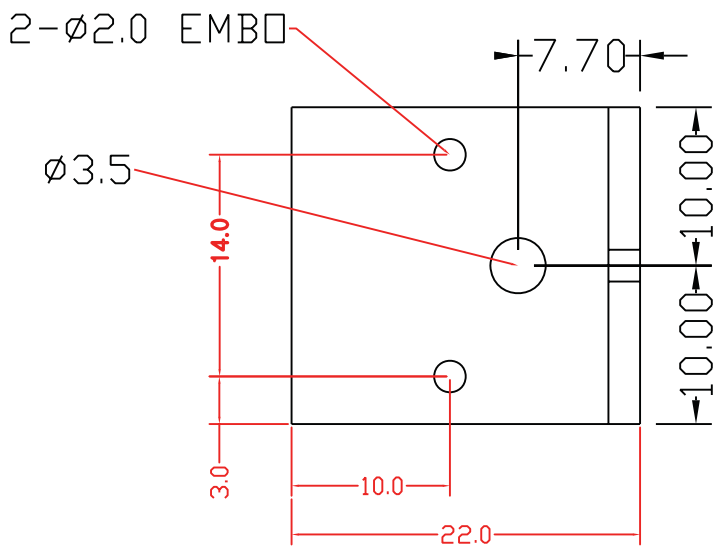
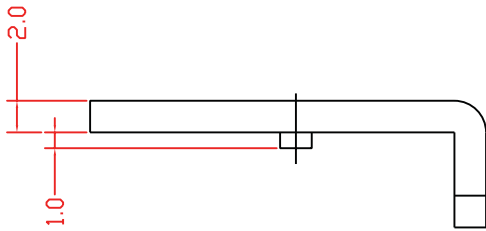

DATE	REVISION RECORD			WRITTEN BY		CHECKED BY	REMARKS
TOLERANCE	SCALE	DRAW	DESIGED	CHECKED	APPROVED	PART NAME	HEATSINK
±0.3	2/1	윤원구				MODEL	CLAMP
DOSUNG PRECISION						E-CODE	E90908168-L